

LAYOUT & MATERIALS NOTES

1. ENSURE THE LOCATION OF ALL EXISTING SERVICES BOTH OLD AND RECENTLY INSTALLED ARE CLEARLY LOCATED ON SITE WITH THE CIVIL ENGINEER PRIOR TO SITE CONSTRUCTION. THE CONTRACTOR WILL BE RESPONSIBLE FOR REPAIRING ALL DAMAGE CAUSED TO SERVICES DURING SITE CONSTRUCTION.
2. LAYOUT MAY BE PROVIDED BY ELECTRONIC FILE OR GEOREFERENCED GRID UPON REQUEST.
3. DO NOT LAYOUT SITE PRIOR TO LOCATING THE NEW BUILDING. USE THE NEW BUILDING AS PRIMARY REFERENCE FOR SITE LAYOUT.
4. ALL DIMENSIONS ARE IN METRES UNLESS OTHERWISE SPECIFIED.
5. STAKEOUT DESIGN AND CONFIRM LAYOUT WITH CONTRACT ADMINISTRATOR ON SITE PRIOR TO INSTALLING HARD SURFACES.
6. REPORT ANY ON SITE DISCREPANCIES TO THE CONTRACT ADMINISTRATOR IMMEDIATELY.
7. SEE DWG L-200 FOR GRADING AND L-300 FOR PLANTING.
8. LAYOUT PLANS WILL BE AVAILABLE IN DWG OR DXF FORMAT FOR GPS LAYOUT.
9. REFER TO SPECIFICATIONS FOR DETAILED MATERIAL DESCRIPTIONS.
10. ANY AREA DISTURBED BY CONSTRUCTION NOT SHOWN ON THIS DRAWING MUST BE RETURNED TO IT'S ORIGINAL CONDITION.

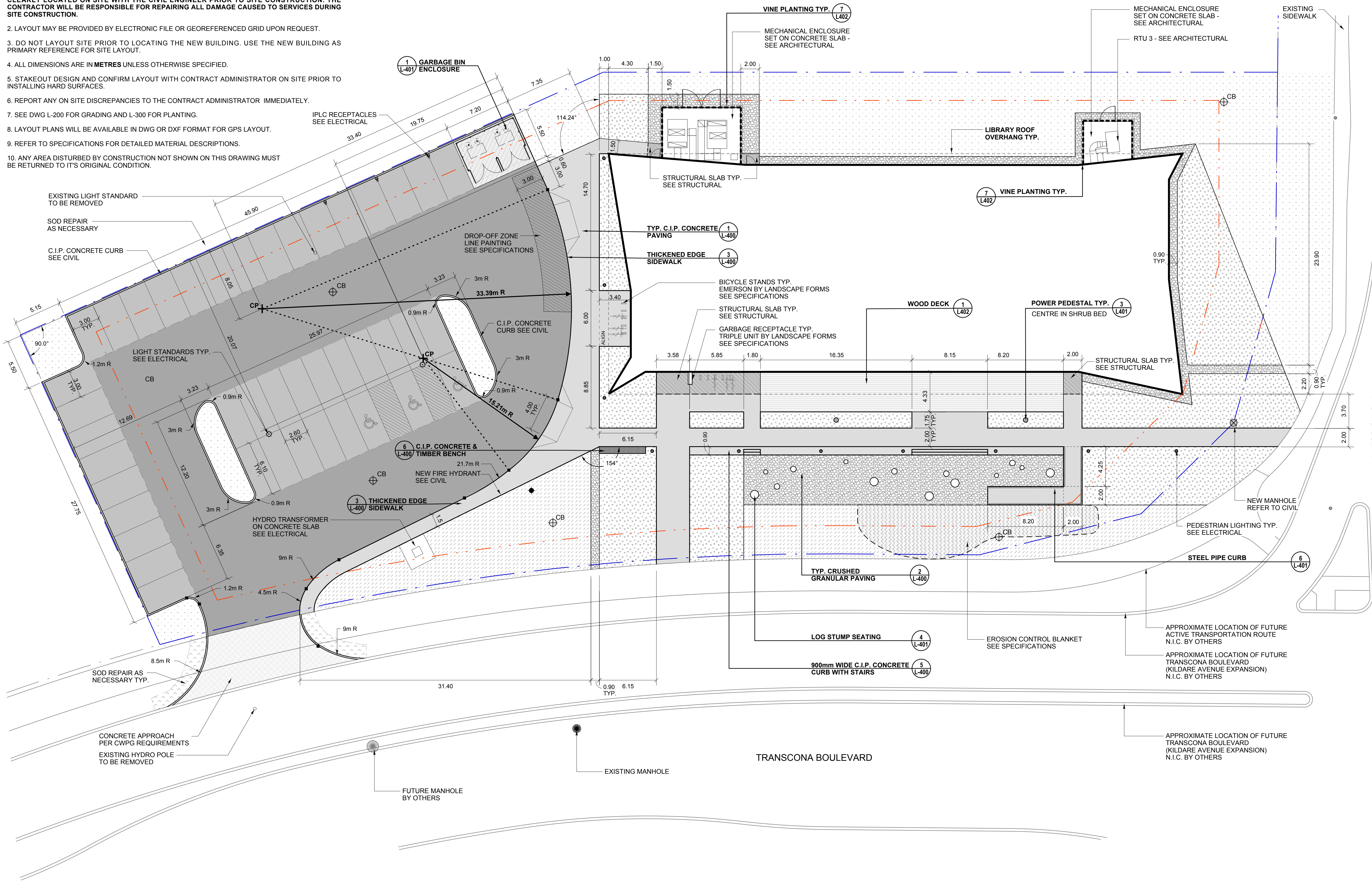

- LEGEND**
- ASPHALT PAVING - HEAVY
 - ASPHALT PAVING - LIGHT
 - CONCRETE PAVING - HEAVY
 - CONCRETE PAVING - LIGHT
 - STRUCTURAL SLAB SEE STRUCTURAL
 - TOPSOIL & SOD
 - TOPSOIL & FESCUE SEED
 - TOPSOIL & MIXED GRASSLAND SEED
 - SHRUB BED WITH MULCH
 - TYP. CRUSHED GRANULAR PAVING
 - WOOD DECK
 - PROPERTY LINE
 - PROPERTY LINE SETBACK
 - THICKENED EDGE CURB
 - CONCRETE CURB
 - 900mm CONCRETE CURB WITH STAIRS
 - NEW CATCHBASIN SEE CIVIL
 - LIGHT STANDARD SEE ELECTRICAL
 - PEDESTRIAN LIGHTING SEE ELECTRICAL
 - IPLC RECEPTACLE SEE ELECTRICAL
 - GARBAGE RECEPTACLE TRIPLE UNIT BY LANDSCAPE FORMS SEE SPECIFICATIONS
 - LOG STUMP SEATING SEE SPECIFICATIONS
 - POWER PEDESTAL

No.	DATE	REVISION / ISSUANCE
4		
3		
2	2017.03.10	Issued for Addenda No.1
1	2017.02.17	Issued for Construction

Seal

Consultant

Architect

Owner

Project

TRANSCONA LIBRARY
1500 PLESSIS ROAD, WINNIPEG, MB

Sheet Title

SITE LAYOUT & MATERIALS PLAN

Project No.

1487

Sheet

L-100

1 SITE LAYOUT & MATERIALS PLAN
L-100 1:200